

Griffe 4 punte

T-nut

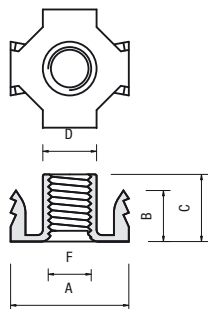

	ART.	A	B	C	D	F	
Acciaio	1101	17	5	7	5,5	4MA	10.000
	1102	17	5	8	6,5	5MA	10.000
	1103	19	7	9	8	6MA	5.000
	1104	19	7	9	8	1/4	5.000
	1105	22	8	11	10	8MA	2.000
	1106	22	8	11	10	7/16	2.000
	1107	25	9	13	12	10MA	2.000

Fondello 3 fori

Bottom 3 holes

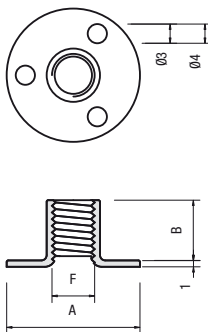

	ART.	A	B	F	
Acciaio	1111	25	11	6MA	5.000
	1112	25	11	8MA	2.000
	1113	25	11	7/16	2.000
	1114	29	11	10MA	2.000

Borchie 6MA testa piana / bombata

Flat / round heat nut 6MA

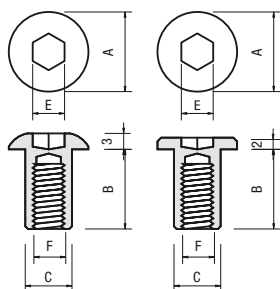

	ART.	A	B	C	E	b	Testa / Head
Acciaio	1421	15	12	9	5	6MA	Piana / Flat
	1422	15	14	9	5	6MA	Piana / Flat
	1423	15	16	9	5	6MA	Piana / Flat
	1424	15	18	9	5	6MA	Piana / Flat
	1431	15	12	9	5	6MA	Bombata / Round
	1432	15	14	9	5	6MA	Bombata / Round
	1433	15	16	9	5	6MA	Bombata / Round
	1434	15	18	9	5	6MA	Bombata / Round
	1441	19	16	9	5	6MA	Piana / Flat
	1442	19	20	9	5	6MA	Piana / Flat
	1451	19	16	9	5	6MA	Bombata / Round
	1452	19	20	9	5	6MA	Bombata / Round

Piedino fisso

Fix leg



Fisso
Fix

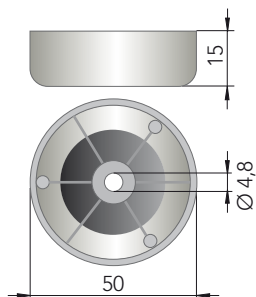

ART.	Ø	X	
5103	50	15	500

Piedino regolabile

Adjustable leg



Regolabile
Adjustable

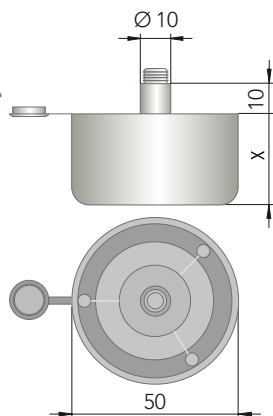

ART.	Ø	X	
5102	50	17	500
5101	50	27	500
5104	50	44	500

Art. 5111



Piedino sottosedia Pratic
Pratic bearing

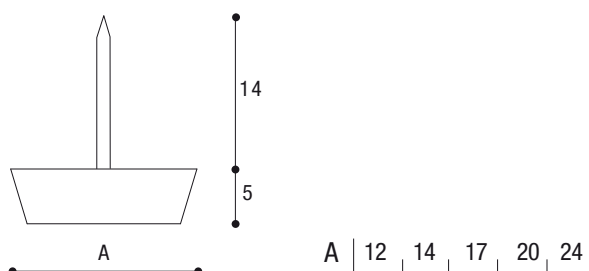

Art. 5112



Piedino sottosedia Pratic alto
High Pratic bearing

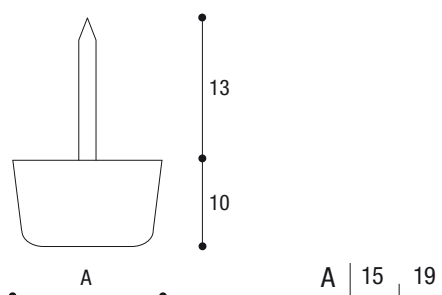

Art. 5113



Piedino sottosedia con feltro
Felt bearing

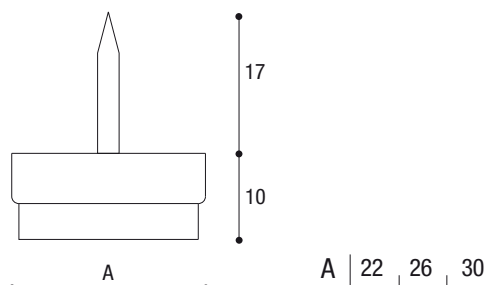

Art. 5114



Piedino sottosedia con feltro a vite
Felt bearing with screw

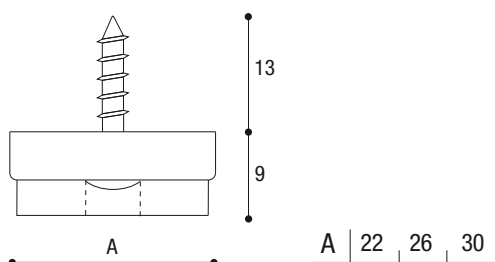

Art. 5121



Scivolo nylon
Nylon slider

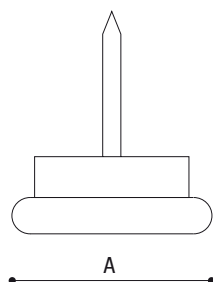

A	18	23	30
---	----	----	----

Art. 5122



Scivolo Pratic
Pratic slider

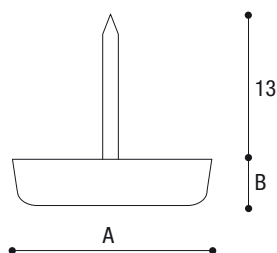

A	12	15	22	28
B	4,5	5,5	5,5	5,5

Art. 5123



Scivolo metallico
Metal slider

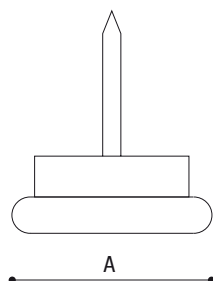

A	15	18	20	23	26	30	40
---	----	----	----	----	----	----	----

Art. 5124



Scivolo metallico a vite
Metal slider with screw

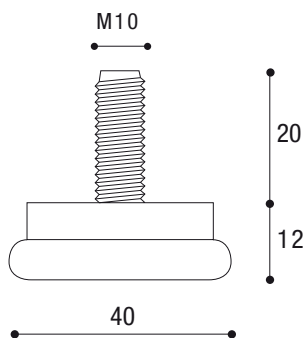

Art. 5131



Pattino a due perni
Slider with two pins

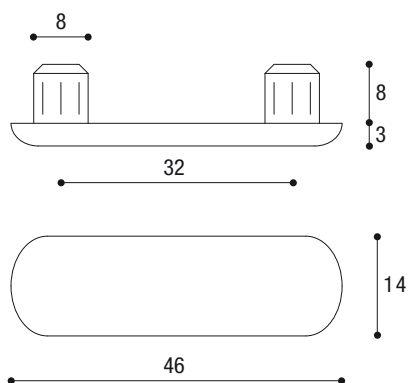

Art. 5132



Pattino Pratic
Pratic slider

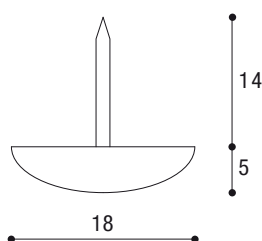

Art. 5141



Spessore a cuneo (8 settori)
Wedge in 8 sections

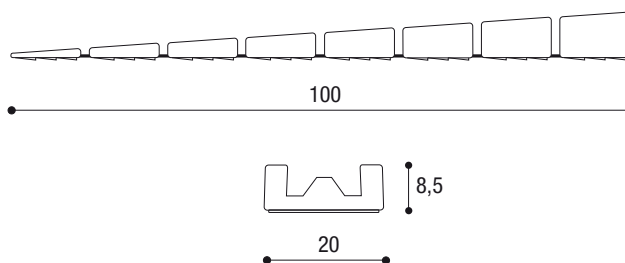

Art. 5142

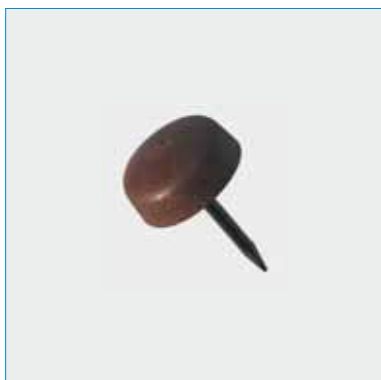

Paracolpo Pratic
Pratic shock absorber

