

Bussola zama c/exag

Zamak exag socket

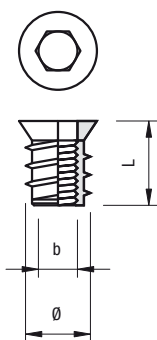

	ART.	Ø	L	b	Preforo / Drilling	
Zama	705	8	10	4MA	6	5.000
	700	10	10	6MA	8	5.000
	701	10	13	6MA	8	5.000
	702	10	15	6MA	8	5.000
	703	10	17	6MA	8	5.000
	704	10	20	6MA	8	5.000
	709	12	13	8MA	10	5.000
	710	12	13	7/16	10	5.000
	711	12	15	8MA	10	5.000
	712	12	15	7/16	10	5.000
	713	12	20	8MA	10	4.000
	714	12	20	7/16	10	4.000
	715	12	25	8MA	10	3.000
	716	12	25	7/16	10	3.000
	717	15	18	10MA	13	2.500

Bussola ottone M6

Brass socket M6

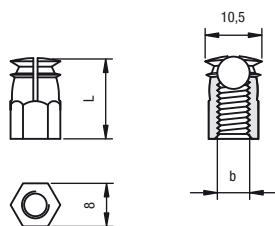

	ART.	EX	L	b		
Ottone	901	8	12	6MA	con sfera / w/ball	5.000
	902	8	12	6MA	senza sfera / wo/ball	5.000

Tutte le nostre bussole sono controllate una a una con una macchina speciale

All our sockets are controlled one by one with a special machinery

Bussola ottone M4

Brass socket M4

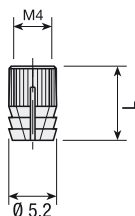

	ART.	Ø	L	X	
Ottone	903	5,2	8	4MA	5.000
	904	5,2	10	4MA	5.000

Bussola nylon

Nylon socket

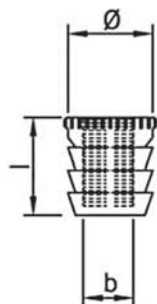

	ART.	Ø	L	b	
Nylon	811	8	8	4MA	5.000
	812	8	11	4MA	5.000
	813	9	10	4MA	5.000
	803	8	11	6MA	5.000
	801	11	11	6MA	5.000
	802	11	13	6MA	5.000

Bussola nylon in strip

Nylon socket in strip

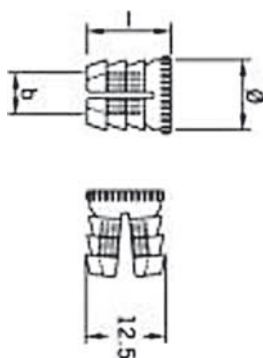

	ART.	Ø	L	b	
Nylon	821	10	10	6MA	5.000
	822	11	13	6MA	5.000

Bussola nylon autofilettante

Nylon self-threaded socket

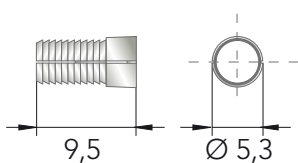

	ART.	Ø	L	Preforo / Drilling	
Nylon	805	5,3	9,5	5	10.000

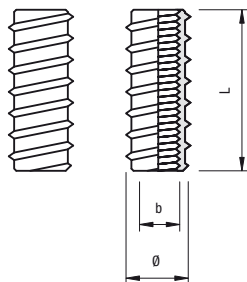

	ART.	Ø	L	b	Preforo / Drilling	
Acciaio	601	9,5	12	6MA 4MA	8	5.000
	602	9,5	15	6MA	8	5.000
	603	9,5	18	6MA	8	5.000
	604	9,5	20	6MA	8	5.000
	606	10	25	6MA	8	4.000
	607	10	30	6MA	8	4.000
	<i>A disegno / On drawing</i>					
	611	12	12	6MA 8MA 7/16	10	5.000
	612	12	15	6MA 8MA 7/16	10	5.000
	614	12	20	6MA 8MA 7/16	10	
	616	12	25	8MA 7/16	10	2.000
	617	12	30	8MA 7/16	10	2.000
<i>A disegno / On drawing</i>						
	621	15	15	6MA 8MA 7/16 10MA	13	2.000
	622	15	20	6MA 8MA 7/16 10MA	13	1.000
	623	15	25	6MA 8MA 7/16 10MA	13	1.000
	624	15	30	6MA 8MA 7/16 10MA	13	1.000
<i>A disegno / On drawing</i>						
	631	16	30	10MA	14	500
	632	16	45	10MA	14	500
<i>A disegno / On drawing</i>						
	641	18	25	12MA	16	500
	642	18	30	12MA	16	500
<i>A disegno / On drawing</i>						

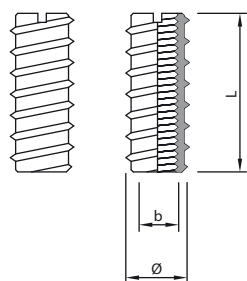

Su richiesta / On request

Con taglio cacciavite / *With slot*

Su richiesta / On request

In ottone / *In brass*

Bussola acciaio spina

Steel pin insert socket

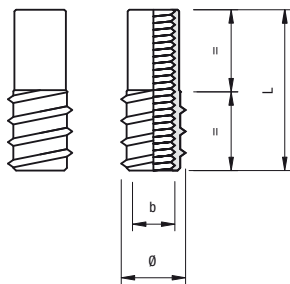

	ART.	Ø	L	b	Preforo / Drilling	
Acciaio	608	10	25	6MA	8	4.000
	618	12	30	8MA 7/16	10	2.000
	625	15	30	10MA	13	1.000

Bussola acciaio speciale

Special steel socket

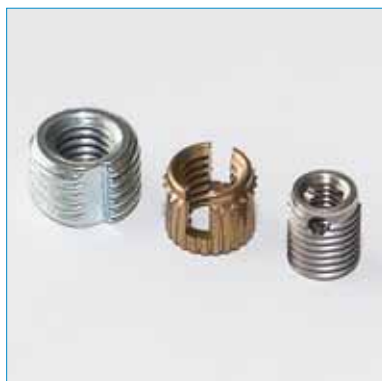

Secondo le esigenze del cliente possiamo produrre bussole con profili speciali per inserimento in materiali duri

According to customer specifications we can produce special sockets for application in harder materials